

DecraLite

ACOUSTIC WALL PANELS



Product Description & Applications

DecraLite™ Acoustic Panels are a recent addition to the Sontext range of internal noise control systems. These systems are designed to provide extensive design flexibility while significantly improving the sound quality of internal spaces by controlling reverberation.

Features & Benefits

- Excellent sound absorption
- Textured, cleanable paint or fabric finish
- High light reflectance (standard finish is flat white)
- Humidity & moisture resistant
- Choice of edge treatments
- Fire resistant
- Lightweight (approx. 4.0kg/m² for 40mm thick panel)

Available Edge Profiles

Square Edge Profile

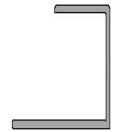

Chamfered Edge Profile

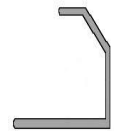

Round Edge Profile

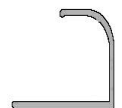

Sound Absorption

SOUND ABSORPTION AT CENTRE FREQUENCIES (Hertz) SHOWN BELOW:

PANEL THICKNESS	125	250	500	100	2000	4000	N.R.C.
25mm	0.15	0.55	1.00	0.95	0.95	0.95	0.85
50mm	0.26	0.71	1.03	1.11	1.09	1.03	1.00
75mm	0.50	1.05	1.05	1.00	1.05	1.00	1.05

The higher the Sound Absorption figure the better the result. As an example, an NRC (Noise Reduction Co-efficient) of 0.85 equates to up to 85% of the sound striking the panel being absorbed. For specifying project work it is recommended that an acoustic engineer be consulted.

DecraSorb Acoustic Wall Panels have been tested in approved acoustic laboratories.

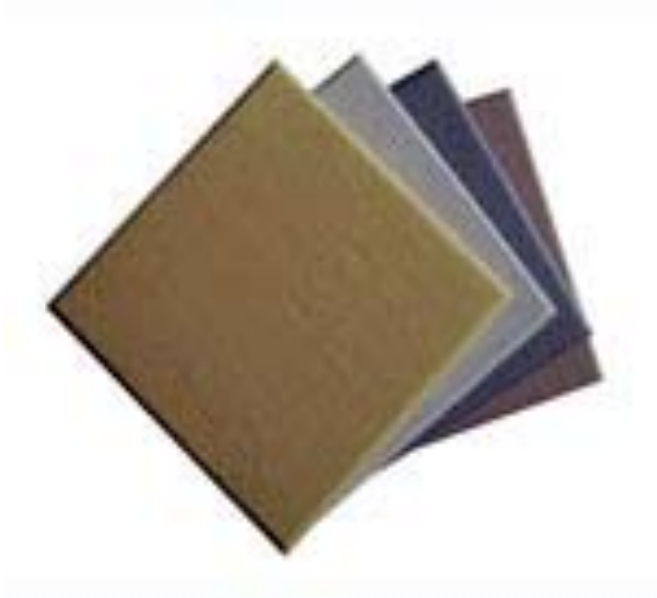

Product Specifications

Length x Width	600x600mm 1200x600mm 1800x600mm 2400x600mm 2700x600mm 1200x1200mm
Thickness	25mm,40mm
Absorption Coefficient	> 0.9 NRC
Moisture Absorption	< 0.7%

Wall Mounts™ Fixing System

DecraLite Wall Mounts (pictured opposite) provide the installer with a simple method of fixing DecraLite Wall Panel to the Wall.

By fixing the Wall Mounts impaler to the wall with mechanical fixings such as screws, the panel can then be secured as in the four step procedure shown in the diagrams below.

Wall Mounting

Mark a line on the wall for top or bottom edge of panels. Place top edge on set out line. Carefully swing bottom edge to meet spike points. With the panel resting on the spike apply pressure in towards wall and downwards as shown below.

Please contact your Decralite Acoustic Panel Distributor for further information.

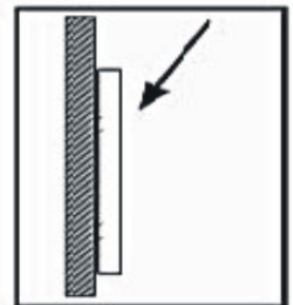
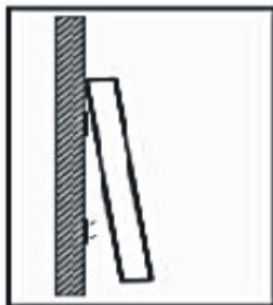
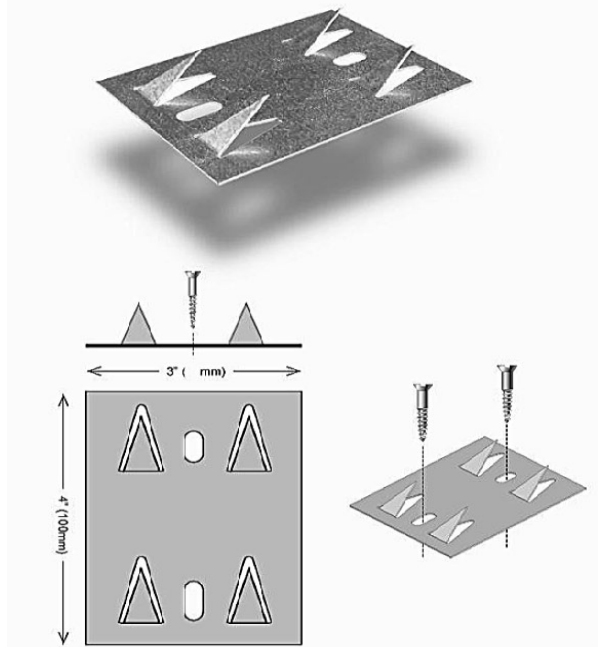

Available From

DecraSound Acoustic Products

Head Office
Unit 4, 99-101 Western Avenue
Westmeadows, Victoria Australia 3049
Web: www.decrasound.com.au
Email: sales@decrasound.com.au

Distributed by: